

PRODUCT UNIT WEIGHTS

NOTES:

- Double tee unit weights are per square foot of deck area. The unit weights listed are for a full width tee. Truncated sections should be calculated individually.
- Wall loads are given per square foot of surface area of wall.

DOUBLE TEES

10'-0" Wide x 24" Deep Tee.....	537 plf 53.7 psf
10'-0" Wide x 24" Deep Tee with 2" topping.....	786 plf 78.6 psf
10'-0" Wide x 26" Deep Tee.....	786 plf 78.6 psf
10'-0" Wide x 28" Deep Tee.....	575 plf 57.5 psf
10'-0" Wide x 28" Deep Tee with 2" topping.....	824 plf 82.4 psf
10'-0" Wide x 30" Deep Tee.....	824 plf 82.4 psf
12'-0" Wide x 24" Deep Tee.....	618 plf 51.5 psf
12'-0" Wide x 24" Deep Tee with 2" topping.....	917 plf 76.4 psf
12'-0" Wide x 26" Deep Tee.....	917 plf 76.4 psf
12'-0" Wide x 28" Deep Tee.....	666 plf 55.5 psf
12'-0" Wide x 28" Deep Tee with 2" topping.....	965 plf 80.4 psf
12'-0" Wide x 30" Deep Tee.....	965 plf 80.4 psf

BRIDGE TEES

8'-0" Wide x 25" Deep Tee w/ 7" Flange.....	1051.7 plf
8'-0" Wide x 31" Deep Tee w/ 7" Flange.....	1152.8 plf
8'-0" Wide x 37" Deep Tee w/ 7" Flange.....	1244.0 plf

DOUBLE LEDGER (INVERTED TEE) BEAMS

2'-0" Wide Web with 11 1/2" Tall Ledges

40" Wide x 34" Deep x 11 1/2" Ledge.....	1042.0 plf
• With 3" Topping.....	1117.0 plf
40" Wide x 35" Deep x 11 1/2" Ledge.....	1067.0 plf
• With 3" Topping.....	1142.0 plf
40" Wide x 36" Deep x 11 1/2" Ledge.....	1092.0 plf
• With 3" Topping.....	1167.0 plf
40" Wide x 37" Deep x 11 1/2" Ledge.....	1117.0 plf
• With 3" Topping.....	1192.0 plf
40" Wide x 38" Deep x 11 1/2" Ledge.....	1142.0 plf
• With 3" Topping.....	1217.0 plf
40" Wide x 39" Deep x 11 1/2" Ledge.....	1167.0 plf
• With 3" Topping.....	1242.0 plf

SINGLE LEDGER BEAMS

2'-0" Wide Web with 11 1/2" Tall Ledge

32" Wide x 34" Deep x 11 1/2" Ledge.....	946.0 plf
• With 3" Topping.....	1021.0 plf
32" Wide x 35" Deep x 11 1/2" Ledge.....	971.0 plf
• With 3" Topping.....	1046.0 plf
32" Wide x 36" Deep x 11 1/2" Ledge.....	996.0 plf
• With 3" Topping.....	1071.0 plf
32" Wide x 37" Deep x 11 1/2" Ledge.....	1021.0 plf
• With 3" Topping.....	1096.0 plf
32" Wide x 38" Deep x 11 1/2" Ledge.....	1046.0 plf
• With 3" Topping.....	1121.0 plf
32" Wide x 39" Deep x 11 1/2" Ledge.....	1071.0 plf
• With 3" Topping.....	1146.0 plf

SINGLE LEDGER BEAMS (CONT'D)

1'-8" Wide Web with 11 1/2" Tall Ledge

28" Wide x 34" Deep x 11 1/2" Ledge.....	804.0	plf
• With 3" Topping.....	867.0	plf
28" Wide x 35" Deep x 11 1/2" Ledge.....	825.0	plf
• With 3" Topping.....	888.0	plf
28" Wide x 36" Deep x 11 1/2" Ledge.....	846.0	plf
• With 3" Topping.....	905.0	plf
28" Wide x 37" Deep x 11 1/2" Ledge.....	867.0	plf
• With 3" Topping.....	925.0	plf
28" Wide x 38" Deep x 11 1/2" Ledge.....	887.6	plf
• With 3" Topping.....	946.0	plf
28" Wide x 39" Deep x 11 1/2" Ledge.....	908.4	plf
• With 3" Topping.....	967.0	plf

1'-8" Wide Web with 9 1/2" Tall Ledge

28" Wide x 31" Deep x 9 1/2" Ledge.....	725.0	plf
• With 3" Topping.....	787.5	plf
28" Wide x 32" Deep x 9 1/2" Ledge.....	745.9	plf
• With 3" Topping.....	808.4	plf
28" Wide x 33" Deep x 9 1/2" Ledge.....	766.7	plf
• With 3" Topping.....	829.2	plf
28" Wide x 34" Deep x 9 1/2" Ledge.....	787.5	plf
• With 3" Topping.....	850.0	plf
28" Wide x 35" Deep x 9 1/2" Ledge.....	808.4	plf
• With 3" Topping.....	870.8	plf

LOAD BEARING SPANDRELS

8" Thickness & 11 1/2" Ledge

5'-0" Height.....	595.8 plf
5'-6" Height.....	645.8 plf
6'-0" Height.....	695.8 plf
6'-6" Height.....	745.8 plf
7'-0" Height.....	795.8 plf

10" Thickness & 11 1/2" Ledge

5'-0" Height.....	720.8 plf
5'-6" Height.....	783.3 plf
6'-0" Height.....	845.8 plf
6'-6" Height.....	908.3 plf
7'-0" Height.....	970.8 plf

8" Thickness & 9 1/2" Ledge

5'-0" Height.....	579.2 plf
5'-6" Height.....	629.2 plf
6'-0" Height.....	679.2 plf
6'-6" Height.....	729.2 plf
7'-0" Height.....	779.2 plf

10" Thickness & 9 1/2" Ledge

5'-0" Height.....	704.2 plf
5'-6" Height.....	766.7 plf
6'-0" Height.....	829.2 plf
6'-6" Height.....	891.7 plf
7'-0" Height.....	954.2 plf

NON-LOAD BEARING SPANDRELS

8" THICKNESS

5'-0" Height.....	500.0 plf
5'-6" Height.....	550.0 plf
6'-0" Height.....	600.0 plf
6'-6" Height.....	650.0 plf
7'-0" Height.....	700.0 plf

10" THICKNESS

5'-0" Height.....	625.0 plf
5'-6" Height.....	687.5 plf
6'-0" Height.....	750.0 plf
6'-6" Height.....	812.5 plf
7'-0" Height.....	875.0 plf

COLUMNS

18" x 18".....	337.5 plf
20" x 24".....	500.0 plf
24" x 24".....	600.0 plf
24" x 28".....	700.0 plf
24" x 30".....	750.0 plf
32" x 32".....	1066.7 plf

WALL PANELS, SHEAR WALLS, LITEWALLS

8" Thick.....	100.0 psf
10" Thick.....	125.0 psf
12" Thick.....	150.0 psf

10 FT WIDE TYPICAL DOUBLE TEES

10' X 26" PT/DT

Normal Weight Concrete

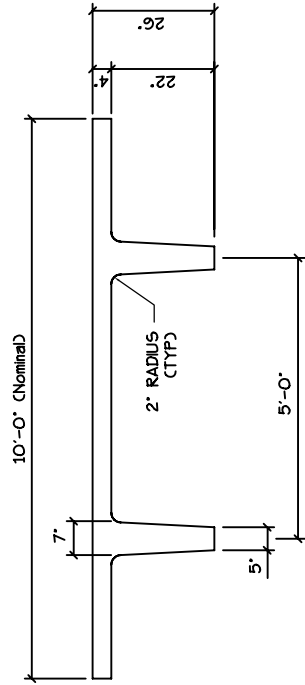

10' X 28" FT/DT

Normal Weight Concrete

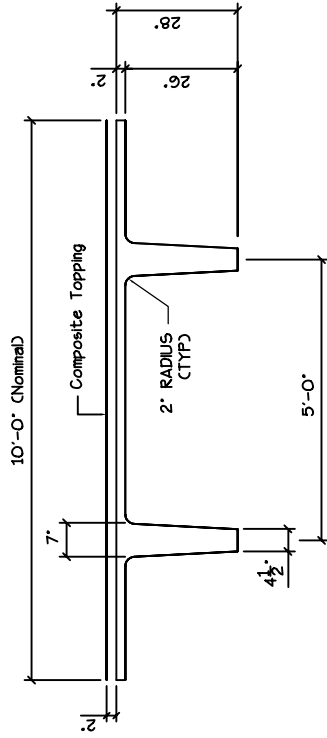

10' X 24" FT/DT

Normal Weight Concrete

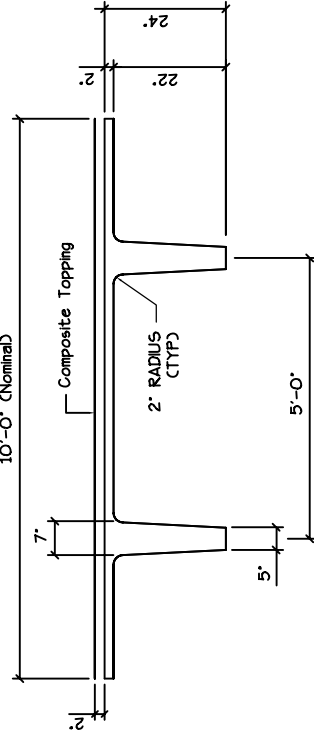

10' X 30" PT/DT

Normal Weight Concrete

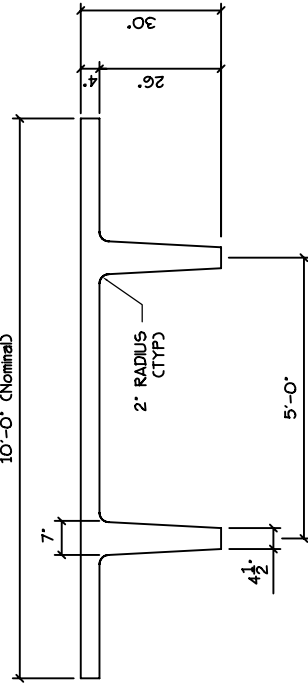

12 FT WIDE TYPICAL DOUBLE TEES

12' X 26" PT/DT

Normal Weight Concrete

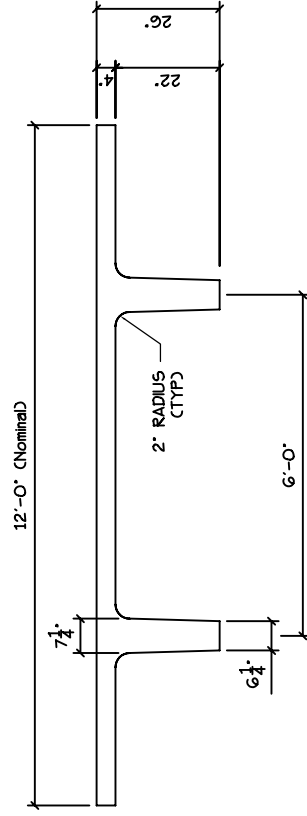

12' X 28" FT/DT

Normal Weight Concrete

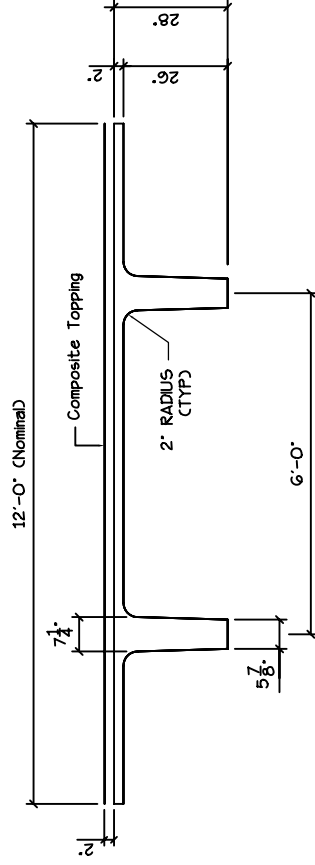

12' X 24" FT/DT

Normal Weight Concrete

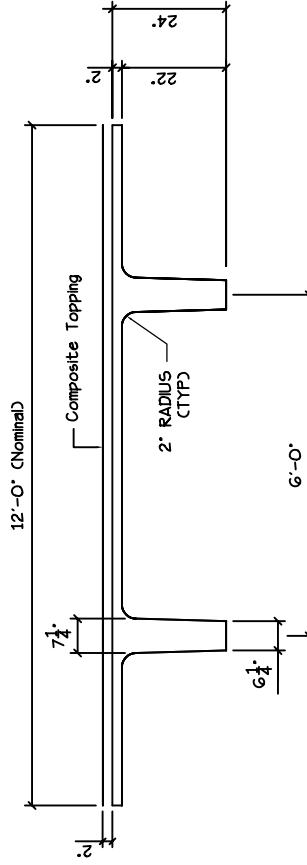

12' X 30" PT/DT

Normal Weight Concrete

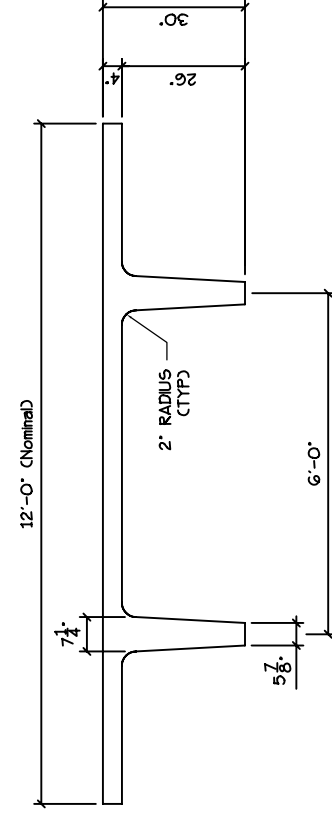

BRIDGE TEES

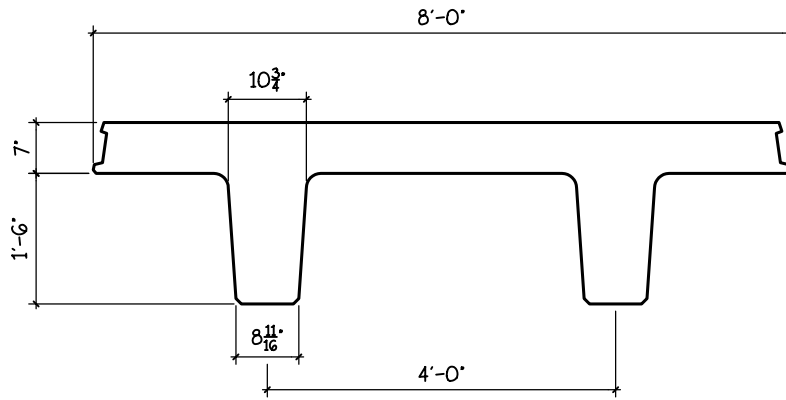

FDT 18

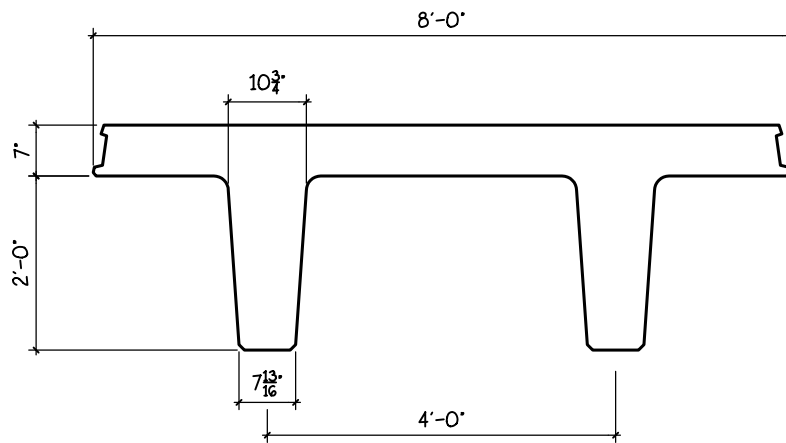

FDT 24

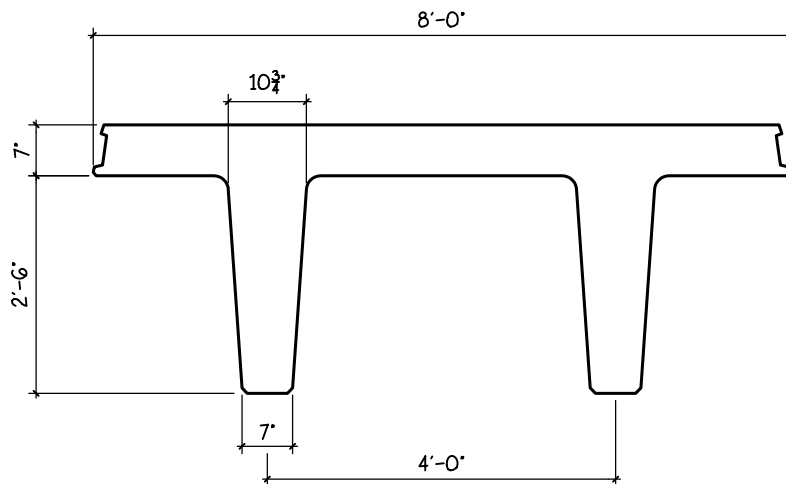

FDT 30

TYPICAL LB AND NLB SPANDRELS

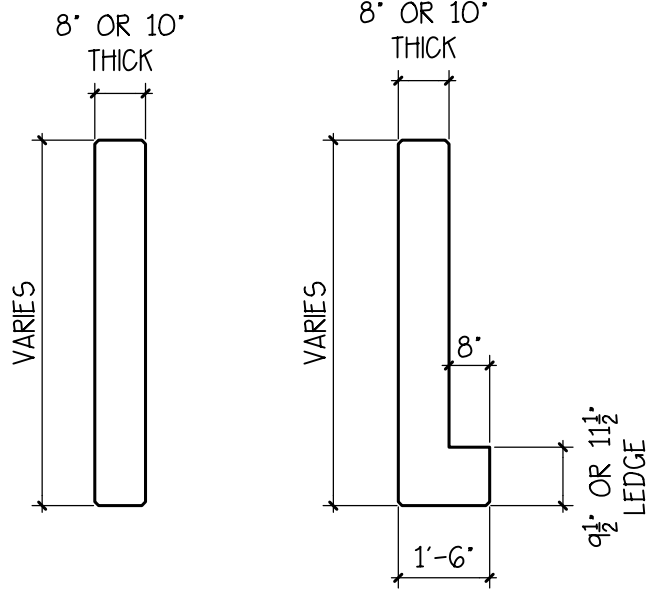

TYPICAL IT BEAMS AND SINGLE LEDGER BEAMS

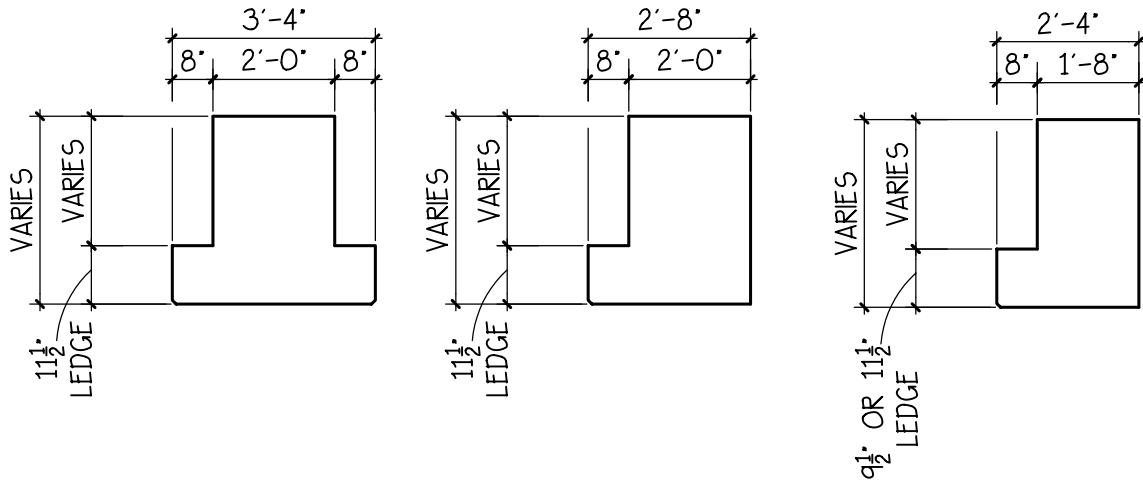

TYPICAL COLUMN SECTIONS

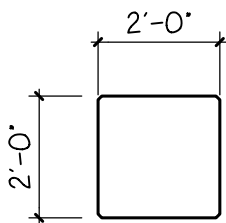

INTERIOR

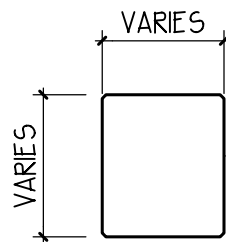

EXTERIOR

TYPICAL EXTERIOR COLUMN SIZES:

- 1) 2'-0" X 2'-0"
- 2) 2'-4" X 2'-0"
- 3) 2'-4" X 2'-4"
- 4) 2'-8" X 2'-0"
- 5) 2'-8" X 2'-4"
- 6) 2'-8" X 2'-8"